

FANTTIK NEX S1 PRO USER MANUAL

Quick Links

[3_How to Use](#)

Table of Contents

[Table of Contents](#)

[Product Storage](#)

[Product Overview](#)

[3_How to use](#)

[Specifications](#)

[Screwdriver Bit Parameters](#)

[Attention](#)

[Warranty Info](#)

[Other ManualsLib Projects](#)

Fanttik

NEX S1 Pro

Cordless Screwdriver Kit

User Manual

Please read this instruction manual carefully before use and keep it for future reference.



Contents

1.Product Storage	02
2.Product Overview	04
3.How to Use	05
4.Specifications	07
5.Screwdriver Bit Parameters.....	08
6.Attention	09
7. Warranty Info.....	10

1.Product Storage

- 1.Protective Lid
- 2.Cordless Screwdriver
- 3.Storage Box
- 4.Screwdriver Bits
- 5.Aluminum Housing

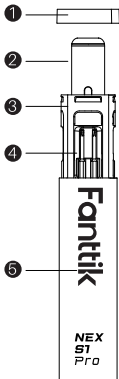

Pop up and store the screwdriver

Press the screwdriver to pop-up from the storage box.

Insert the screwdriver into the storage box and press down to lock.

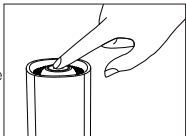

Pop up and store the storage box

Press the storage box (curved top surface) to pop-up from the aluminum housing.

Insert the storage box into the aluminum housing and press down to lock.

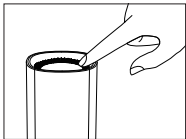

Storage of screwdriver bits

The 16 bits are attached in bit holder on the storage box and are attracted by magnet. Put bits back in place according to the corresponding bit icons after use.

2.Product Overview

6.Screwdriver Bit

7.1/4" Bit Holder

8.LED Light

9.Torque Knob

10.Forward/Reverse Rotation Button

11.Power Indicator

12.Type-C Charging Port

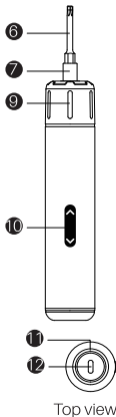

Bottom view



Top view

3.How to Use

Screwdriver power on/off

- Turn the torque knob from OFF to any desired level, then press the forward/reverse rotation button to start the screwdriver.
- Turn the torque knob to OFF to turn off the screwdriver.

Turn on/off the LED light

- The LED light turns on simultaneously when the screwdriver is turned on.
- The LED light will stay on for 10 seconds without any operation.
- The LED light will turn off when the torque knob is turned to OFF.

Forward/Reverse rotation button

Press the Forward  /Reverse  rotation button to tighten or loosen a screw.

Torque knob

- Turn the knob to level **I** to set to low torque mode.
- Turn the knob to level **II** to set to medium torque mode.
- Turn the knob to level **III** to set to high torque mode.

Power Indicator

- When the battery level is below 20% in use, the indicator will rapidly blink red, and it will turn off in 5 seconds after the rotation button is released.
- When charging, the indicator will slowly blink white.
- When the battery is fully charged, the indicator will become solid white.

Battery charging

This screwdriver is equipped with a universal Type-C charging port, and comes with a USB charging cable. Charger is not included, please use a 5V charger for charging.

4.Specifications

Product Name	Cordless screwdriver kit
Product Model	NEX S1 Pro
Color	Deep grey
Product dimension	67*67*220mm
Screwdriver dimension	184 x Φ 35 mm
Net Weight	860g
Max. torque of level I	1.5 N·m
Max. torque of level II	3 N·m
Max. torque of level III	4.2 N·m
Max. hard torque	6 N·m
Max. manual torque	8 N·m
Rotation speed (unloaded)	220 RPM
Battery capacity	2000mAh/7.4Wh
Charging Input	5V/1A

5.Screwdriver Bit Parameters

Bit Shank: 1/4-inch (6.3mm) hex shank

Bit Length: 20 inch (50 mm)

Bit Material: Coated S2 Steel

Bit list:

Phillips: PH0, PH1, PH2

Slotted: SL3, SL4, SL5

Tamperproof Torx: TR10, TR15, TR20, TR25

Internal Hex: H3, H4, H5, H6

Square Recess: S1, S2

6.Attention

- Avoid moisture, dust, and drop.
- Do not store the product in extreme temperature environment.
- Stay alert, watch what you are doing and use common sense when operating. Do not operate while you are tired or under the influence of drugs, alcohol or medication.
- This product is not a toy and should not be used by kids under 5 years old.
- This product has built-in battery, do not throw it into fire and should be recycled by local laws and regulations.
- Do not dismantle the machine by yourself. Have your power tool serviced by a qualified repair person or contact us for advice.

Warranty Info

⦿ **Your Warranty Includes**

- **12-Month Coverage**

Within 12 months of purchase, we will provide timely and effective online after-sales service. We will repair or replace any defective product (due to manufacturing fault) within the warranty period.

⦿ **How to Return Your Fanttik Product**

- Contact support@fanttik.com with your order number.

- ⦿ If your purchase was fulfilled by Amazon, please use Amazon's 30-day return service.

Please visit the official website for Declaration of Conformity.

METASEE LLC

5205 Broadway #634 Pearland Texas 77581

www.fanttik.com

support@fanttik.com

Made in China



CE **FC** **RoHS** **IC**

Other ManualsLib Projects



www.manualslib.com



www.manualslib.de



www.manualslib.es



www.manualslib.fr



www.manualslib.nl



www.manualslib.mx



www.manualslib.tech 30+ Languages